

LAP2 (4FT)

CUSTOMER PROJECT

Project: _____
 Type: _____
 Cat. No.: _____
 Qty: _____
 Date: _____
 EEL Rep: _____



Telephone: 905 415 8878 Fax Number: 905 415 8872 Toll Free Telephone: 855 415 8878 Toll Free Fax: 855 415 8872

DESCRIPTION

The Prism 2 follows the success of our original linear architectural LED Prism series. The second generation still features a modern prismatic design for indoor spaces, but is now also colour selectable and suitable for 120-347V applications for even greater versatility.

Add architectural drama to offices, work spaces, retail, and reception areas with optional uplighting. The simple yet stylish Prism 2 can be suspension-, surface-, or recess- mounted and is available in custom configurations with optional end joints and one-piece lens lengths.

SPECIFICATION FEATURES

Construction

- Casing made of one-piece 6063 aluminum frame
- High quality powder coating finishing
- Performance-engineered lens
- Optional custom end joints available (Contact us for details)
- 10 ft 5-conductor cord included

Mounting

- Surface Mount
- Suspension Mount
- Recessed Mount
- Wall Mount
- Easy end-to-end continuous row mount with included connector plate
 - Every 2 fixtures require ≥3 mounting points
 - Every 4 fixtures require ≥5 mounting points
 - Continuously row mount up to 20 x 4' units

Finish

- Textured White
- Textured Black

Beam Angle

- 120°

Shielding

- Opal polycarbonate lens delivers unique beam angles and reduces glare.

Compliance

- cUL
- Suitable for damp locations

Warranty

- 5-Year Warranty (Standard)
- 10-Year Limited Warranty (Optional)



LAP2 SERIES (4FT)

Linear Architectural Prism 2

Wattage(s)	40W
Voltage	120-347V
Dimmable	0-10V
CCT	3CCT-F (35K / 40K / 50K)
Efficacy	115lm/W
Lumen Maintenance	L70 > 136,000h Lumen maintenance at 36,000 hrs = 91.1%
CRI	>80
Inherent Surge Protection	2.0kV
Power Factor	>0.9
Total Harmonic Distortion	<20%
Max. Dimming Source Current	450uA
Operating Temperature	-20°C to 40°C

- 120" (10ft) air craft cable and ceiling canopies for suspension mount
- Fixture Weight: 6.41lbs/2.91kg

Note: Not recommended to be used in application with chemical processing; for applications with chemical processing, fixtures rated for IP65 and higher are recommended



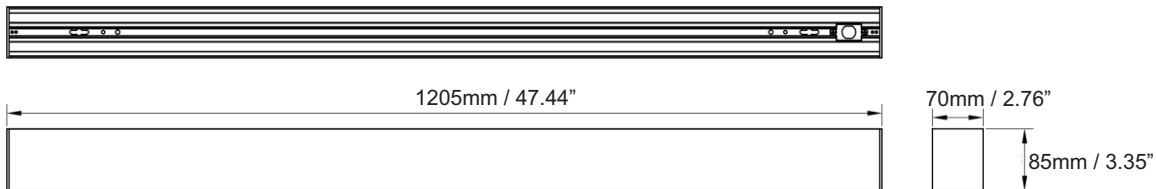

LAP2-4472

Dimensions

mm | 1205(L) x 70(W) x 85(H)
inch | 47.44(L) x 2.76(W) x 3.35 (H)

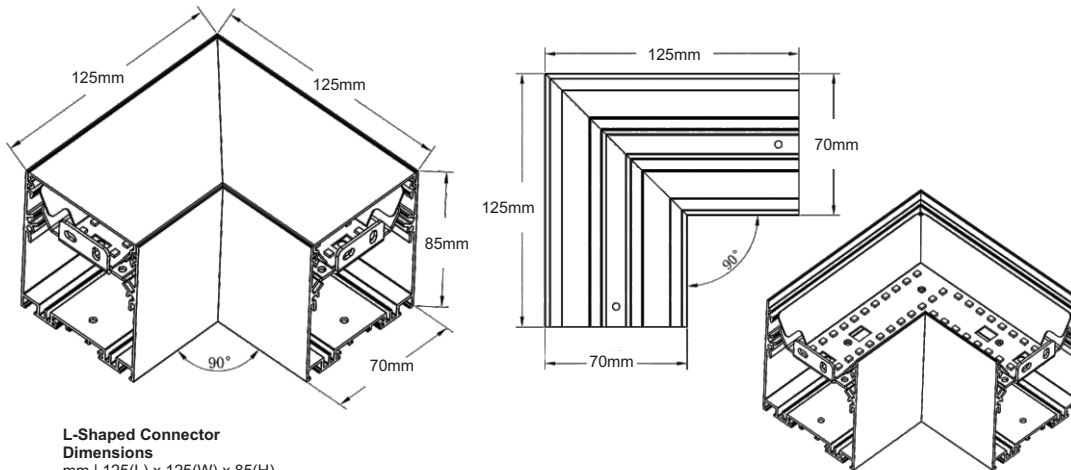













L-Shaped Connector

Dimensions

mm | 125(L) x 125(W) x 85(H)
inch | 4.9(L) x 4.9(W) x 3.35 (H)



ORDERING CODE, ENERGY AND PERFORMANCE DATA

Model Length	Model No.	Delivered Lumens (lm)	Input Watts (W)	Voltage (V)	Colour Temp. (K)	Efficacy (lm/W)	Certification
2'	 LAP2-2172 Textured White 20W3CCTF-120347V-010V-E115 (In-Development)	2300	22	120-347	3CCT-F (3500K / 4000K / 5000K)	115	
2'	 LAP2-2172 Textured Black 20W3CCTF-120347V-010V-E115 (In-Development)	2300	22	120-347	3CCT-F (3500K / 4000K / 5000K)	115	
2'	 LAP2-2172 (Textured White / Textured Black) + LAP2-2-A2103-UML (In-Development)	552 (24%) Uplight 1748 (76%) downlight	22	120-347	3CCT-F (3500K / 4000K / 5000K)	115	
4'	 LAP2-4472 Textured White 40W3CCTF-120347V-010V-E115	4600	40	120-347	3CCT-F (3500K / 4000K / 5000K)	115	
4'	 LAP2-4472 Textured Black 40W3CCTF-120347V-010V-E115	4600	40	120-347	3CCT-F (3500K / 4000K / 5000K)	115	
4'	 LAP2-4472 (Textured White / Textured Black) + LAP2-4-A2103-UML	1150 (24%) Uplight 3450 (76%) downlight	40	120-347	3CCT-F (3500K / 4000K / 5000K)	115	

NOTE:
• Lumens are estimated

ACCESSORIES INCLUDED

LAP-10ACC | Linear Architectural Prism 10ft Aircraft cable + Ceiling Canopies (matte white / textured white / textured black)
LAP-Connector | Linear Architectural Prism Connector
Power Cord | 10 ft 5-conductor cord (white)

OPTIONAL ACCESSORIES

Custom Power Cord | 5-conductor cord in custom length and colour (white/black)
LAP2-U-A2104-LCTW | Linear Architectural Prism L-Shape Connector, 3CCT-F, Textured White (only downlight available)
LAP2-U-A2104-LCTB | Linear Architectural Prism L-Shape Connector, 3CCT-F, Textured Black (only downlight available)
LAP-CUSTOMLENS | Custom lens in desired length available (Multiples of 4 is required)
LAP2-4-A2103-UML | Uplight Module & Lens for 4ft LAP2
LAP-RMA | 4ft Recessed Flanged Mount
LAP-RMB | 4ft Recessed Mud-in Mount
PRISM-U-A2107-MKWALL | Wall Mount Kit (Coming Soon)

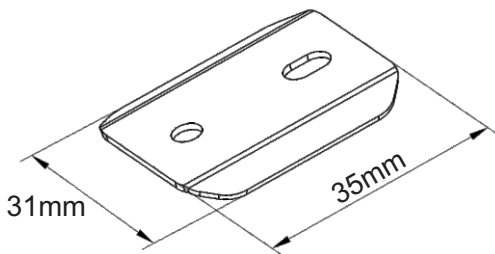

LAP-Connector

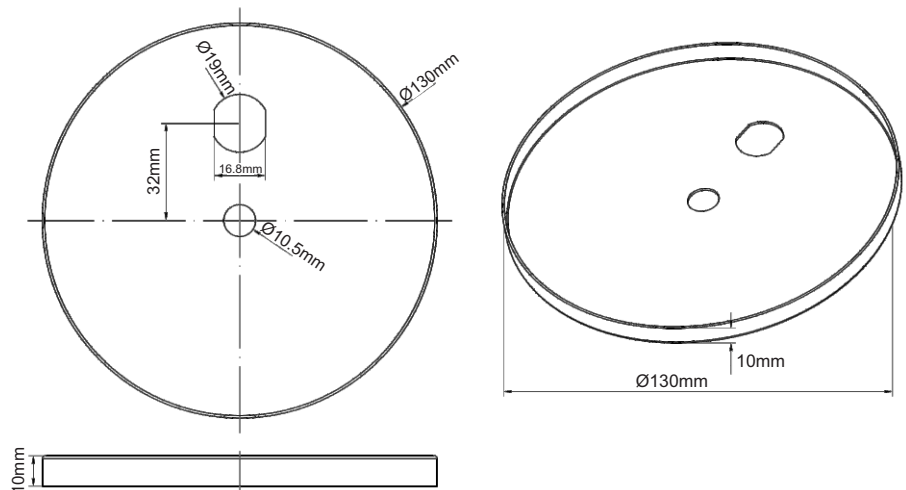

Ceiling Canopy



APPLICATION

